



Chicago City Clerk-Council Div.  
2022 MAY 31 PM3:00

OFFICE OF THE CITY CLERK  
CITY OF CHICAGO  
ANNA VALENCIA

NOTICE OF INTENT FORM

1. Submit a complete and accurate description of the precinct you wish to restrict.

The description of the precinct boundaries of the 37<sup>th</sup> Precinct of the 23<sup>rd</sup> Ward of the City of Chicago in the County of Cook and the State of Illinois, as such precinct existed as of the last General Election, is as follows:

Please see attached

2. Please select the scope of restriction sought for the 37<sup>th</sup> Precinct of the 23<sup>rd</sup> Ward:

A: Restricting Shared Housing Units and Vacation Rentals

- ☒ Restrict all new or additional *shared housing units AND vacation rentals*.  
☐ Restrict all new or additional *shared housing units*.  
☐ Restrict all new or additional *vacation rentals*.

OR

B: Restricting Shared Housing Units and Vacation Rentals that are NOT their owner's Primary Residence:

- ☐ Restrict all new or additional *shared housing units AND vacation rentals* that **ARE NOT** their owner's or tenant's primary residence.  
☐ Restrict all new or additional *shared housing units* that **ARE NOT** their owner's or tenant's primary residence  
☐ Restrict all new or additional *vacation rentals* that **ARE NOT** their owner's or tenant's primary residence.

SEAN MURRAY  
Petitioner Name

  
Signature

5/31/22  
Date

# PCT 37 WARD 23



## Legend

-  Precinct Boundary
-  Freeway
-  Major Street
-  Local Street
-  Service Drive
-  Ramp
-  Alley
-  Streams
-  Railroad

Board of Elections  
City of Chicago  
69 W Washington, Suite 600  
Chicago, IL 60602  
312-269-7900  
  
[www.chicagoelections.com](http://www.chicagoelections.com)

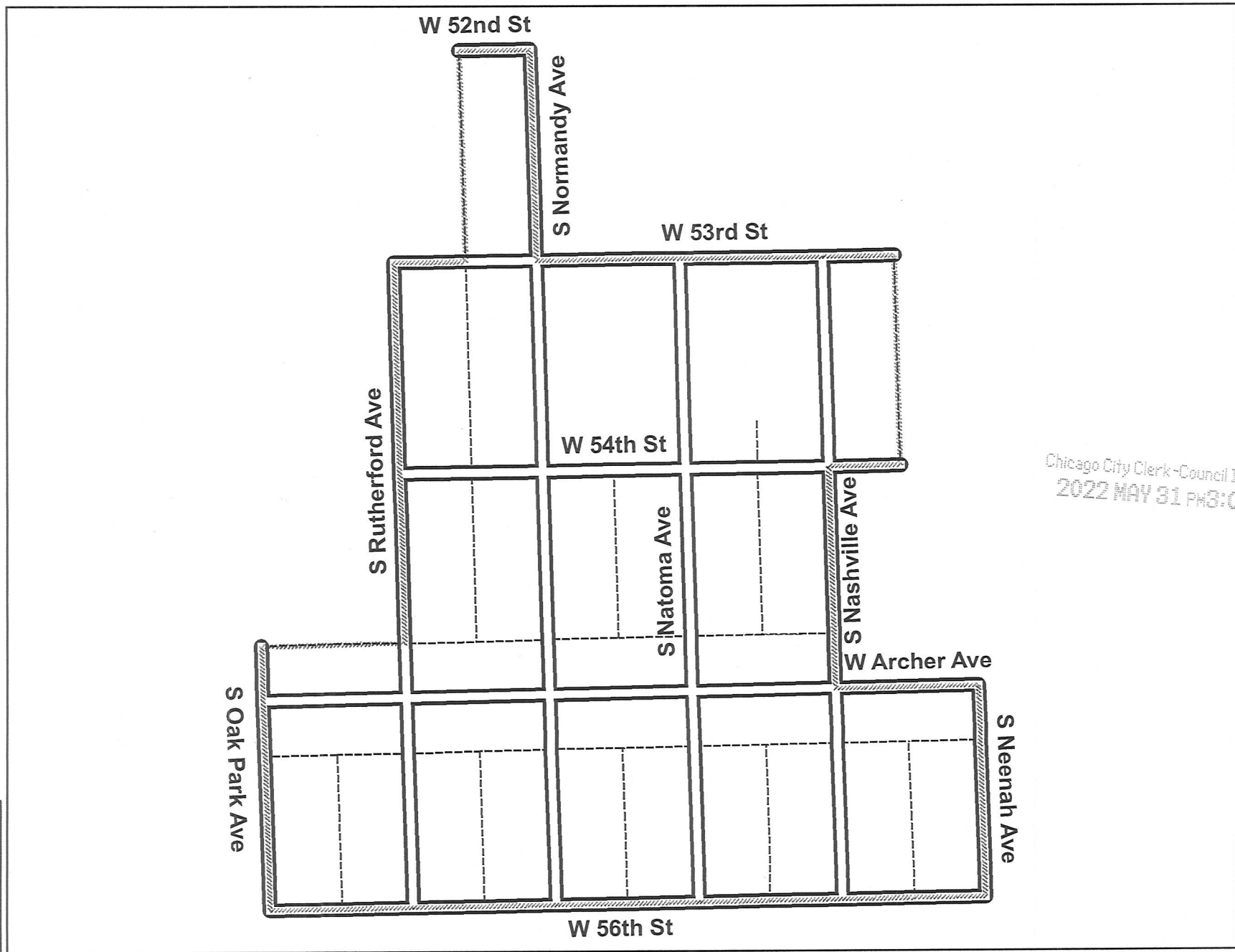

Chicago City Clerk - Council Div.  
2022 MAY 31 PM3:00

## PCT 37    WARD 23

Beginning at the intersection of the alley west of S. Normandy Av. and W. 52<sup>nd</sup> St., thence east on W. 52<sup>nd</sup> St. to S. Normandy Av., thence south on S. Normandy Av. to W. 53<sup>rd</sup> St., thence east on W. 53<sup>rd</sup> St. to the alley east of S. Nashville Av., thence south on the alley east of S. Nashville Av. to W. 54<sup>th</sup> St., thence west on W. 54<sup>th</sup> St. to S. Nashville Av., thence south on S. Nashville Av. to W. Archer Av., thence east on W. Archer Av. to S. Neenah Av., thence south on S. Neenah Av. to W. 56<sup>th</sup> St., thence west on W. 56<sup>th</sup> St. to S. Oak Park Av., thence north on S. Oak Park Av. to the alley north of W. Archer Av., thence east on the alley north of W. Archer Av. to S. Rutherford Av., thence north on S. Rutherford Av. to W. 53<sup>rd</sup> St., thence east on W. 53<sup>rd</sup> St. to the alley west of S. Normandy Av., and north on the alley west of S. Normandy Av. to the place of beginning.

---