



CITY OF CHICAGO

OFFICE OF THE CITY CLERK
ANNA M. VALENCIA

NOTICE OF INTENT FORM

1. Submit a complete and accurate description of the precinct you wish to restrict.

The description of the precinct boundaries of the 2 Precinct of the 23 Ward of the City of Chicago in the County of Cook and the State of Illinois, as such precinct existed as of the last General Election, is as follows:

SEE ATTACHMENT

2. Please select the scope of restriction sought for the 2 Precinct of the 23 Ward:

Restricting a Cannabis Zone

- Restrict *home cultivation*;
- Restrict *one or more types of cannabis business establishments:*
(Please check all that apply)
 - Cultivation Center*
 - Craft Grower*
 - Processing Organization*
 - Infuser Organization*
 - Dispensing Organization*
 - Transporting Organization*
- Restrict *home cultivation AND one or more types of cannabis business establishments:*
(Please check all that apply)
 - Cultivation Center*
 - Craft Grower*
 - Processing Organization*
 - Infuser Organization*
 - Dispensing Organization*
 - Transporting Organization*

Roselia Velasco _____ January 10, 2024
 Petitioner Name Signature Date Office of the Chicago City Clerk
 2024 JAN 12 AM 10:27

WARD 23 PCT 2



- Legend
- Precincts
 - Freeway
 - Major Street
 - Local Street
 - Ramp
 - Service Drive
 - Alley
 - Waterways
 - Railroad

Board of Elections - City of
Chicago
69 W. Washington, Suite 600,
Chicago, IL 60602
312-269-7900
www.chicagoelections.gov

Date: 1/31/2023

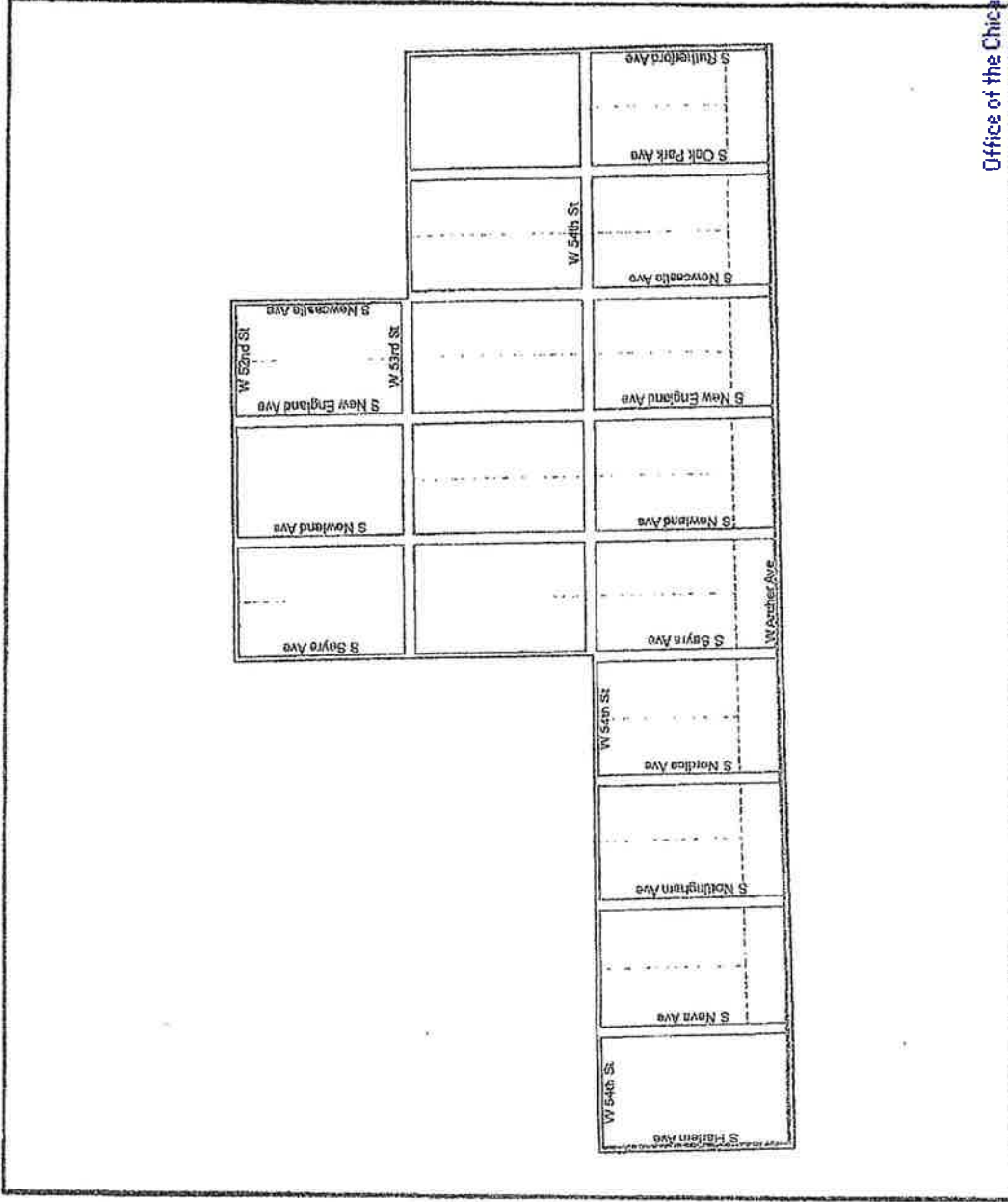

Office of the Chicago City Clerk
2,000 2024 JAN 12 AM 10:27
US Feet



WARD 23 PCT 2

Beginning at the intersection of S Sayre Ave and W 52nd St, thence east on W 52nd St to the intersection of W 52nd St and S Newcastle Ave, thence south on S Newcastle Ave to the intersection of S Newcastle Ave and W 53rd St, thence east on W 53rd St to the intersection of W 53rd St and S Rutherford Ave, thence south on S Rutherford Ave to the intersection of S Rutherford Ave and W Archer Ave, thence west on W Archer Ave to the intersection of W Archer Ave and S Harlem Ave, thence north on S Harlem Ave to the intersection of S Harlem Ave and W 54th St, thence east on W 54th St to the intersection of W 54th St and S Sayre Ave, thence north on S Sayre Ave to the place of the beginning.