



CITY OF CHICAGO

OFFICE OF THE CITY CLERK  
ANNA M. VALENCIA

**NOTICE OF INTENT FORM**

Chicago City Clerk - Council Div.  
2024 FEB 7 PM 4:06

**1. Submit a complete and accurate description of the precinct you wish to restrict.**

The description of the precinct boundaries of the 6 Precinct of the 23 Ward of the City of Chicago in the County of Cook and the State of Illinois, as such precinct existed as of the last General Election, is as follows:

SEE Attachment

**2. Please select the scope of restriction sought for the 6 Precinct of the 23 Ward:**

**Restricting a Cannabis Zone**

- Restrict *home cultivation*;
- Restrict *one or more types of cannabis business establishments:*  
(Please check all that apply)
  - Cultivation Center*
  - Craft Grower*
  - Processing Organization*
  - Infuser Organization*
  - Dispensing Organization*
  - Transporting Organization*
- Restrict *home cultivation AND one or more types of cannabis business establishments:*  
(Please check all that apply)
  - Cultivation Center*
  - Craft Grower*
  - Processing Organization*
  - Infuser Organization*
  - Dispensing Organization*
  - Transporting Organization*

Arlene White  
Petitioner Name

Arlene W. White  
Signature

2/7/2024  
Date

# WARD 23 PCT 6



- Legend**
- Precincts
  - Freeway
  - Major Street
  - Local Street
  - Ramp
  - Service Drive
  - Alley
  - Waterways
  - Railroad

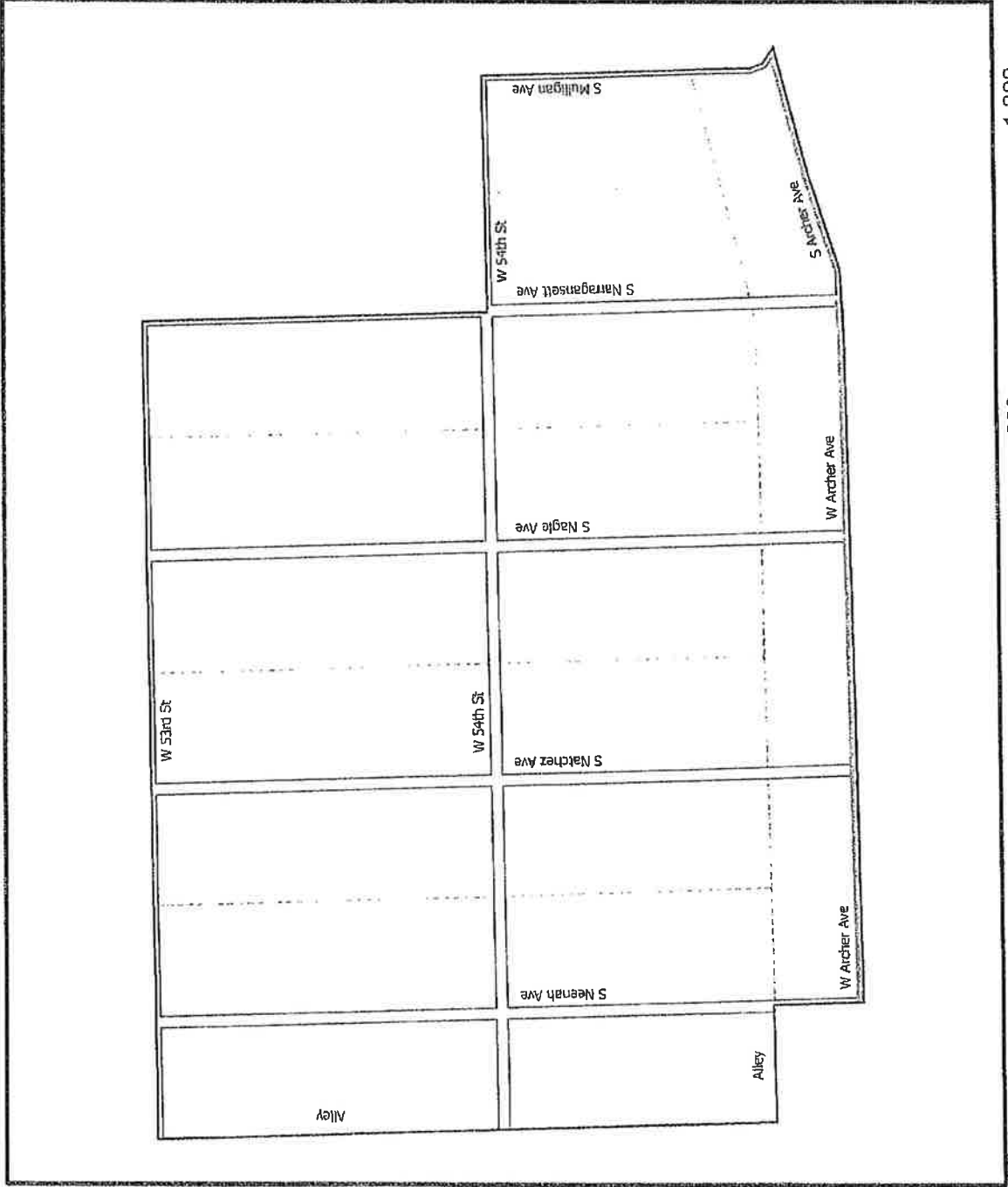

Board of Elections - City of  
 Chicago  
 69 W Washington, Suite 600,  
 Chicago, IL 60602  
 312-269-7900  
[www.chicagoelections.gov](http://www.chicagoelections.gov)

Date: 1/31/2023



## WARD 23 PCT 6

Beginning at the intersection of the Alley (west of S Neenah Ave) and W 53rd St, thence east on W 53rd St to the intersection of W 53rd St and S Narragansett Ave, thence south on S Narragansett Ave to the intersection of S Narragansett Ave and W 54th St, thence east on W 54th St to the intersection of W 54th St and S Mulligan Ave, thence south on S Mulligan Ave to the intersection of S Mulligan Ave and S Archer Ave, thence southwest on S Archer Ave to the intersection of S Archer Ave and W Archer Ave, thence west on W Archer Ave to the intersection of W Archer Ave and S Neenah Ave, thence north on S Neenah Ave to the intersection of S Neenah Ave and the Alley (north of W Archer Ave), thence west on said Alley to intersection of said Alley and the Alley (west of Neenah Ave), thence north on said Alley to the place of the beginning.